

HB2 概述

感谢您购买旷世音响的HiFi Hub HB2。HB2是旷世音响无损便携播放器的HiFi扩展设备。它可以为播放器充电,也可以作为独立的USB DAC使用,还可以与播放器搭配作为台式讯源,输出模拟音频信号和数字音频信号并连接其他设备使用。HB2支持旷世音响QP2R及后续型号的无损便携播放器。

包装配件清单

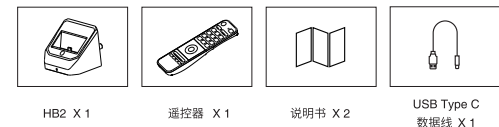

技术规格

电源电压	USB Type C , 5V/2A
静态功耗	0.3W
最大功耗	8.8W (给播放器以最大电流充电时)
数字输出	RCA接口的同轴数字输出, 标准PCM 44.1K-192K/16-24bit信号
模拟输出	RCA单端; 2Vrms; THD+N<0.0008% @ 1kHz; SNR>110dB
最大外部尺寸	85mm[L] x 82.5mm[W] x 71.2mm[H]

⚠ 同轴SPDIF输出时, PCM384kHz数据转换为PCM192kHz输出, DSD数据转化为PCM方式输出。

HB2 概述

正视图

- 1 USB Type C接口
- 2 红外遥控接收区
- 3 双色指示灯

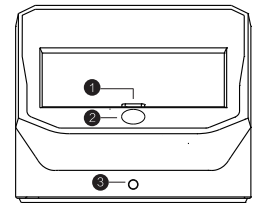

指示灯工作状态说明

- 红、橙色灯交替闪烁: HB2已上电, 但未连接播放器
- 红色灯闪烁: HB2正在给播放器充电
- 红色灯常亮: 播放器充满电
- 橙色灯常亮: 播放器插在HB2上, 正常播放
- 橙灯闪烁: 播放器插在HB2上, 播放器正在配置
- 指示灯快闪两下: HB2已经接收到遥控器按键指令
- 指示灯快闪四下: HB2已经调整到最大音量输出

后视图

- 1 数字同轴输出接口
- 2 左声道模拟输出接口
- 3 右声道模拟输出接口
- 4 DC 5V/2A电源输入接口

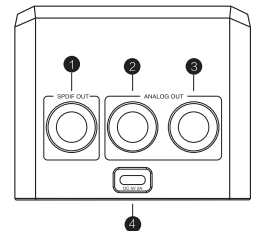

遥控器功能说明

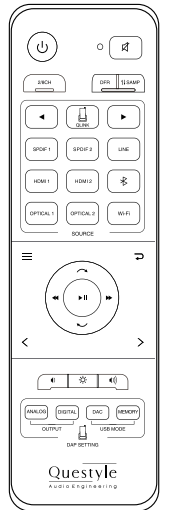

· 讯源切换区域

由于是旷世通用遥控器, 这部分在HB2上不可用。

· DAP控制区域

分别与播放器的触控按键、转盘以及确认键的功能对应(不支持快进、快退功能)。

· 系统和音量控制区域

音量大小控制, 及播放器的“HiFi Hub输出设定”和“USB设置”。

准备工作

安装遥控器电池

- 电池型号: AAA 7号 1.5V
- 向上打开遥控器后方的电池盖(图一)
- 依图示放入2颗7号电池后盖上电池盖(图二)

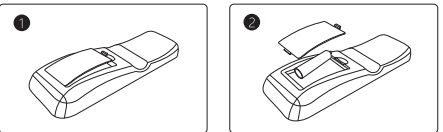

播放器软件更新

- 请把播放器QP2R的软件更新到V1.0.1版本以上, 软件更新方法如下:
- 从旷世官网下载最新软件, 解压后拷贝文件“DAP003GL.upt”到Micro SD卡, 插入卡槽;
 - 启动机器, 选择“系统设置-固件升级-是”;
 - 成功升级后屏幕会提示升级完成。

⚠ HB2目前只支持旷世音响QP2R无损便携播放器。

HB2使用说明

给播放器充电

- 在把播放器插在HB2上后, 请用USB Type C线连接电脑或者适配器, HB2会自动对播放器(内部电池)进行充电。
- 使用5V/2A的适配器充电, 约耗时4小时; 使用电脑充电, 时间要适当延长。
- 当播放器有信号输出时, 为保证音频性能, 此时HB2停止给播放器充电。

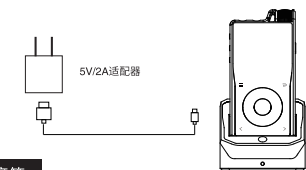

搭配有源音箱

HB2与播放器作为台式模拟讯源, 搭配有源音箱使用

- 把HB2模拟输出连接到有源音箱对应的模拟输入接口;
- 把HB2通过USB Type C线连接到电源;
- 把播放器“HiFi Hub输出设定”设置为“模拟”, 如果需要在播放器端调整系统音量, 请将“HiFi Hub模拟输出音量”设置为“可调节”;
- 把播放器插在HB2上, 当播放器屏幕显示“QP2R已成功连接到HiFi Hub”时, 说明连接成功;
- 通过控制遥控器或直接操作播放器即可正常使用。

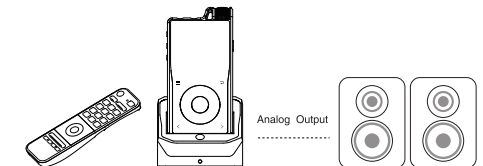

HB2使用说明

搭配台式解码器

HB2与播放器作为数字转盘输出数字信号

- 把HB2数字输出接口连接对应的数字输入接口;
- 把HB2通过USB Type C线连接到电源;
- 把播放器的“HiFi Hub输出设定”设置为“数字”;
- 把播放器插在HB2上, 当播放器屏幕显示“QP2R已成功连接到HiFi Hub”时, 说明连接成功;
- 通过控制遥控器或直接操作播放器即可正常使用。

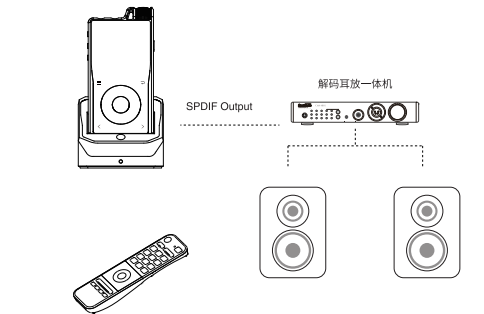

HB2使用说明

搭配台式HiFi功放

HB2与播放器作为台式模拟讯源, 搭配台式HiFi功放使用

- 把HB2模拟输出连接到HiFi功放对应的模拟输入接口;
- 把HB2通过USB Type C线连接到电源;
- 把播放器的“HiFi Hub输出设定”设置为“模拟”, 如果HiFi功放支持音量调节功能, 请将“HiFi Hub模拟输出音量”设置为“最大”;
- 把播放器插在HB2上, 当播放器屏幕显示“QP2R已成功连接到HiFi Hub”时, 说明连接成功;
- 通过控制遥控器或直接操作播放器即可正常使用;

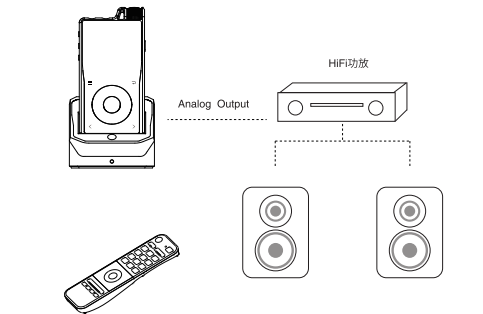

HB2使用说明

作为USB DAC使用

HB2与播放器作为USB DAC使用

- 在电脑端安装好播放器对应的驱动程序(请前往旷世官网www.questyle.com > 下载中心 > 驱动下载中, 下载 QP2R USB DAC Driver 驱动程序);
- 把HB2输出连接到对应的输入接口;
- 把HB2通过USB Type C线连接到电脑;
- 把播放器“USB设置”设定为“DAC”模式;
- 把播放器插在HB2上, 当播放器屏幕显示为“DAC模式”, 说明连接成功;
- 请正确选择HB2的输出模式, 运行电脑上的播放程序(包括视频播放程序)就可将音乐数据送至播放器解码。

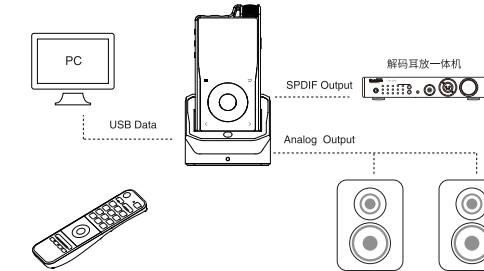

注意: 播放器的驱动要求和设置要求请参考《QP2R说明书》“USB DAC功能”部分的操作说明。

⚠ 如本产品出现故障, 请联系本地代理商, 切勿自行拆机。
• 本机所配遥控器中不含电池, 请用户按照本说明书中指定型号自行购买。

Contact us

旷世科技有限公司 | Questyle Audio Technology Co.,Ltd
 Add: Room No.13A, Floor 13, Yunsong Building, The 8th Tairan Road, Futian District, Shenzhen, China 518040
 Tel: +86-755-82835670; +86-755-82840732
 Email: info@questyle.com
 Wechat: questyle



[www.questyle.com]



[官方微博公众号]

本公司保留此说明书的最终解释权, 设计、技术参数及配件等如有更改, 恕不另行通知。
 Questyle Audio reserves the right of final explanation to this manual. Design or specifications are subject to change without prior notice.
 CODE: CE-UM010-HB2V171023

HB2 Introduction

Thank you for buying Questyle Audio HB2. HB2 is a HiFi Hub for extending outputs of Questyle Audio Digital Audio Players(DAP). It can be used as a DAP charger. When linking to the DAP, it can work as a desktop source with analog and digital outputs, or as a USB DAC. HB2 is only applicable to Questyle Audio QP2R High-Res Portable Audio Player and later models of Questyle DAPs.

In the Box

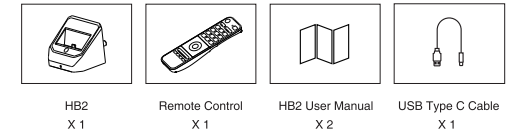

Specifications

Power supply	USB Type C , 5V/2A
Static power consumption	0.3W
Max power consumption	8.8W (when charging DAP under max current)
Digital out	SPDIF out (RCA), PCM44.1-192K /16-24bit
Analog out	RCA: 2Vrms; THD+N<0.0008%@1kHz; SNR>110dB
Dimension	85mm[L] x 82.5mm[W] x 71.2mm[H]

! In SPDIF output, signals sampling at PCM384kHz will be converted to PCM192kHz. DSD signals are processed in PCM format.

HB2 Introduction

Front View

- 1 USB type C port
- 2 Remote control sensor
- 3 Working status indicator

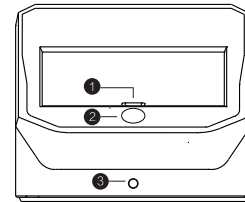

Indicator Description

- The indicator flickers alternately in red and orange: HB2 is powered on but not linked to a Questyle Audio DAP yet.
- Orange indicator flickers only: HB2 is charging for the DAP.
- Orange indicator stays light on: the DAP is fully charged.
- Red indicator stays light on: the DAP is on the HB2 and playing music files.
- Red indicator flickers only: the DAP is on the HB2 and configuring.
- The lighting indicator flickers twice fast: HB2 has received signals from the remote control.
- The lighting indicator flickers 4 times fast: HB2 volume is set to Max.

Rear View

- 1 SPDIF out
- 2 Left channel analog out
- 3 Right channel analog out
- 4 DC 5V/2A charging port

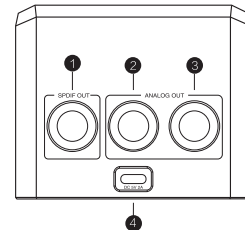

Remote Control

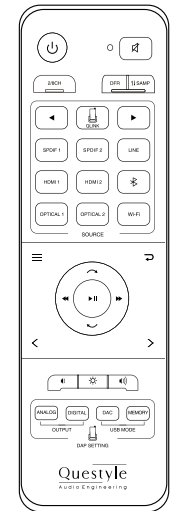

- Source Control Buttons**
These buttons are inactive on HB2.
- DAP Control Buttons**
These buttons function as the touch buttons, wheel and OK button correspondingly to those on the DAP. (Not performing the function of fast forward or fast backward.)
- System and Volume Control Buttons**
These buttons function as volume control, and correspondingly as the DAP settings for "HiFi Hub output" and "USB".

Getting Started

Install Battery

- Battery type: AAA #7 alkaline battery, 1.5V
- Open the back cover. (See Fig.1)
- Put in 2 required batteries then shut the cover. (See Fig.2)

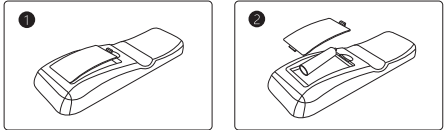

Update DAP Firmware

- Please update the QP2R firmware to V1.0.1 or later version.
- Download the latest firmware from Questyle Audio website and unzip it, then copy file "DAP003GL.upt" to a micro SD card and insert it into the card slot of your DAP.
- Start your DAP and select "Settings" - "Update firmware" - "Begin".
- After update, the display will show "Update is finished".

! HB2 is currently applicable to Questyle Audio QP2R only.

HB2 Function Options

Charging DAP Battery

- Put your DAP onto HB2 and then link HB2 to your PC or an adapter with a USB type C cable to charge DAP battery.
- DAP battery will be fully charged in about 4 hours via a 5V/2A adapter. It will take a little longer to be fully charged via PC.
- When the DAP is working, to guarantee its audio performance, HB2 will stop charging.

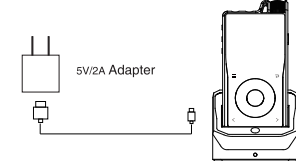

Matching HB2 & DAP with Active Speakers

- HB2 and DAP can be used as a desktop analog source to match with active speakers.
- Link the analog output of HB2 to the analog input of active speakers.
- Link HB2 to its power supply via a USB type C cable.
- Go to your DAP and select "Settings"- "HiFi Hub output"- "Analog". If the volume needs to be adjusted via the DAP, please set the "HiFi Hub analog out volume" of the DAP to "Adj".
- Put your DAP onto HB2. When the DAP screen shows "QP2R is successfully linked to HiFi Hub", HB2 and DAP are ready to work.
- Play music files via the remote control or the controls on your DAP.

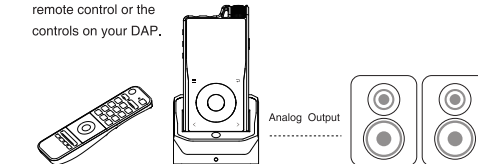

HB2 Function Options

Matching HB2 & DAP with Digital Devices

- HB2 and DAP can be used as a digital transport to match with other digital devices.
- Link the digital output of HB2 to the digital input of another digital device.
- Link HB2 to its power supply via a USB type C cable.
- Go to your DAP and select "Settings"- "HiFi Hub output"- "Digital".
- Put your DAP onto HB2. When the DAP screen shows "QP2R is successfully linked to HiFi Hub", HB2 and DAP are ready to work.
- Play music files via the remote control or the controls on your DAP.

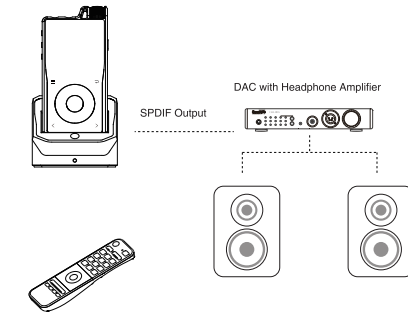

HB2 Function Options

Matching HB2 & DAP with a HiFi Power Amplifier

- HB2 and DAP can be used as a desktop analog source to match with a HiFi power amplifier.
- Link the analog output of HB2 to the analog input of a HiFi power amplifier.
- Link HB2 to its power supply via a USB type C cable.
- Go to your DAP and select "Settings"- "HiFi Hub output"- "Analog". If the volume of the HiFi power amplifier can be adjusted, please set the "HiFi Hub analog out volume" of the DAP to "Max".
- Put your DAP onto HB2. When the DAP screen shows "QP2R is successfully linked to HiFi Hub", HB2 and DAP are ready to work.
- Play music files via the remote control or the controls on your DAP.

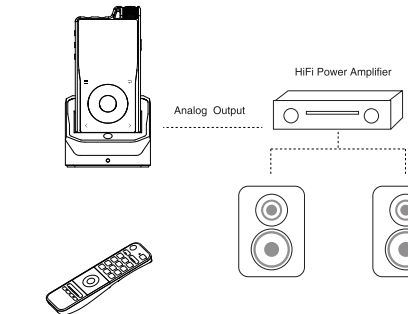

HB2 Function Options

Using HB2 & DAP as USB DAC

- HB2 and DAP can be used as a USB DAC.
- Install the required Driver onto your PC. [Visit Questyle Audio website www.questyleaudio.com, click "Download"- "Driver" and select "QP2R USB DAC Driver.zip"]
- Link the output of HB2 to the input of another device.
- Link HB2 to your PC via a USB type C cable.
- Go to your DAP and select "Settings"- "USB"- "DAC".
- Put your DAP onto HB2. When the DAP screen shows "USB DAC", HB2 and DAP are ready to work.
- Select a right output of HB2 and play music files with the player on your PC.

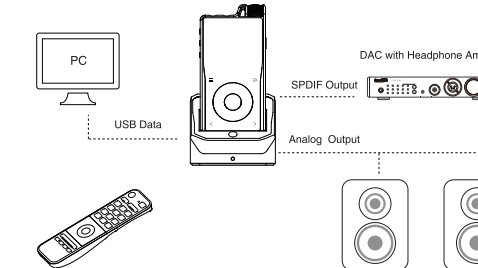

Note:
 Please refer to QP2R User Manual - "QP2R USB DAC" for instructions on DAP Driver and settings.

! In case any faulty happens, please contact Questyle Audio authorized dealer. Do not disassemble HB2 by yourself. Battery for the remote control is not included in the package. Please buy 2 matching batteries according to the specified battery type.